

RTD WITH WEATHER PROOF ENCLOSURE ART 1004-A

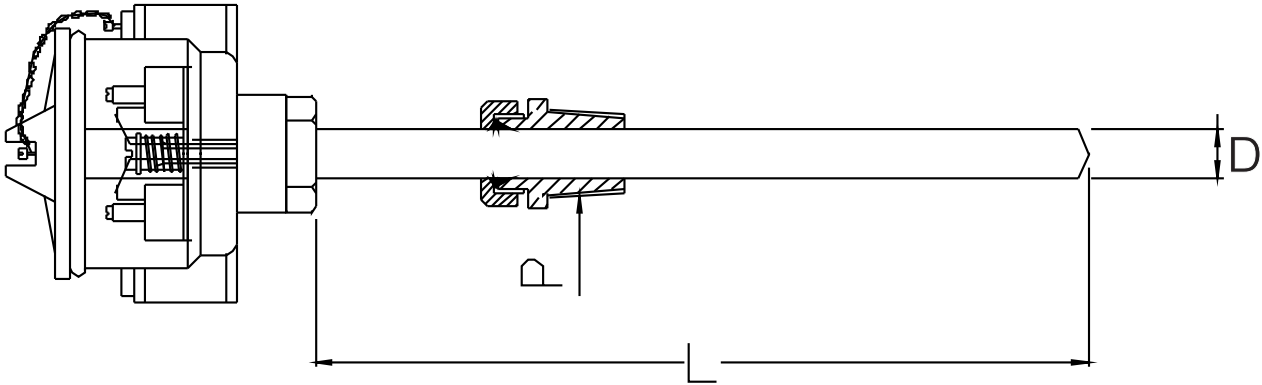

Head	Cable Gland	"P" Process Connection Size	RTD	Accuracy
------	-------------	-----------------------------	-----	----------

Material	No. of Entries	Cable Entries Size	Entries Plugged
A C. Alu. WP		01 3/4" ET	
D SS 304 WP		02 1/2 NPT	
G SS 316 WP		XX Others	
1 Single Entry		1	
2 Dual Entry		x None	

O None
 A W. P. Single Compression Brass Ni Plated
 B W. P. Double Compression Brass Ni Plated
 X Others

02 1/2" BSP 03 3/4" BSP
 02A 1/2" NPT 03A 3/4" NPT
 09. Others

DIN 43760/IEC 751
 A Class A
 B Class B

RTD Type	No. of Elements	Extension Configuration	Insulation	Sheath MOC	"D" Sheath DIA	"L" Sheath Length
PT-100 X Others	S Simplex D Duplex	A 2 Wire B 3 Wire C 4 Wire	01 Beaded with MgO Filling.	01 SS304 02 SS316	1 6 mm 2 8 mm X ___mm	_____mm

ART 1004-A

An ISO 9001 : 2008 company

Corporate & Mktg. Office : 165, G.I.D.C. Makarpura, Vadodara 390 010. **Tel. : +91 - 265 - 2643550, 2646021.**
■ Fax : + 91 - 265 - 2641054 ■ E-mail : marketing@altopindustries.com

Factory : 392 , 419-A, GIDC, Makarpura, Vadodara - 390 010.
■ Tel. : 0265-2658480 ■ E-mail : support@altopindustries.com

MUMBAI : 5, Turakhia Park, Shopping Complex, Building No. 1, Next to Corporation Bank, M. G. Road, Khandivali (W) MUMBAI - 400 067. **■ Tel. : (022) 2806 6032 / 2806 6036 ■ Fax : (022) 2862 9113**
■ Email : bombay@altopindustries.com



ALTOP Industries Ltd.

PROCESS CONTROL INSTRUMENTATION

CIN - U91110GJ1993PLC018831

<http://www.altopindustries.com>