

# THERMOCOUPLE WITH FLAME PROOF ENCLOSURE AND NUN ATC 1003-E

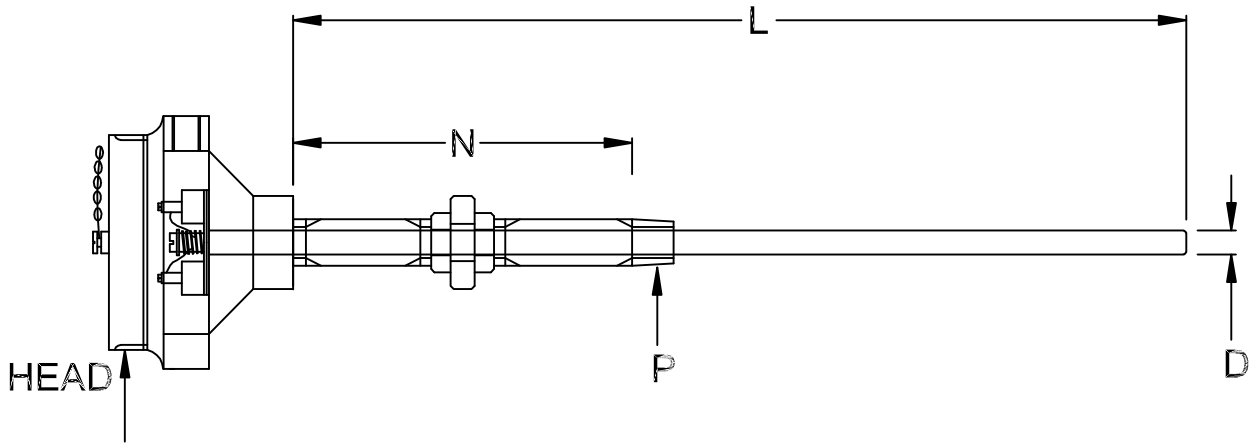

Head	Cable Gland	"N" Lag Extension	Nipple Connection Size "P"	Thermocouple	Certification	Accuracy																																
<table border="1"> <thead> <tr> <th>Material</th> <th>No. of Entries</th> <th>Cable Entries Size</th> <th>Entries Plugged</th> </tr> </thead> <tbody> <tr> <td>B C. Alu. FLP-I / IIA / IIB</td> <td>01</td> <td>3/4" ET</td> <td></td> </tr> <tr> <td>C C. Alu. FLP-IIC</td> <td>02</td> <td>1/2" NPT</td> <td></td> </tr> <tr> <td>E SS 304 FLP-I / IIA / IIB</td> <td></td> <td></td> <td></td> </tr> <tr> <td>H SS 316 FLP-I / IIA / IIB</td> <td></td> <td></td> <td></td> </tr> <tr> <td>xx Others</td> <td></td> <td></td> <td></td> </tr> <tr> <td>1 Single Entry</td> <td>1</td> <td></td> <td></td> </tr> <tr> <td>2 Dual Entry</td> <td>x</td> <td>None</td> <td></td> </tr> </tbody> </table>	Material	No. of Entries	Cable Entries Size	Entries Plugged	B C. Alu. FLP-I / IIA / IIB	01	3/4" ET		C C. Alu. FLP-IIC	02	1/2" NPT		E SS 304 FLP-I / IIA / IIB				H SS 316 FLP-I / IIA / IIB				xx Others				1 Single Entry	1			2 Dual Entry	x	None							
Material	No. of Entries	Cable Entries Size	Entries Plugged																																			
B C. Alu. FLP-I / IIA / IIB	01	3/4" ET																																				
C C. Alu. FLP-IIC	02	1/2" NPT																																				
E SS 304 FLP-I / IIA / IIB																																						
H SS 316 FLP-I / IIA / IIB																																						
xx Others																																						
1 Single Entry	1																																					
2 Dual Entry	x	None																																				
<p>O None</p> <p>C FLP-1/IIA/IIB Double Compression Brass Ni Plated</p> <p>D FLP-IIC Double Compression Brass Ni Plated</p> <p>X Others</p>																																						
<p>1 CS Nipple Union Nipple 150mm</p> <p>2 SS 304 Nipple Union Nipple 150mm</p> <p>3 SS 316 Nipple Union Nipple 150mm</p>																																						
<p>02 1/2" BSP</p> <p>02A 1/2" NPT</p>																																						
					<p>C1 CMRI</p> <p>C2 CCOE</p> <p>C3 BIS</p> <p>C4 DIGIFASLI</p> <p>C5 ATEX</p> <p>C6 DGMS</p>	<p>ANSI MC 96.1</p> <p>A Standard</p> <p>B Special</p>																																

Thermocouple Type	No. of Elements	Type of Junction	Insulation	Sheath MOC	Sheath DIA "D"	Sheath Length mm "L"
J	S Single	0G	01 Mineral	03 SS310	6 mm	_____ mm
K	D Double	Grounded	Insulated	04 SS316	8 mm	
T		UG		06 SS321	x others	
E		Ungrounded		13 Inconel 600		
N						
R						
S						
B						

ATC 1003-E

An ISO 9001 : 2008 company

Corporate & Mktg. Office : 165, G.I.D.C. Makarpura, Vadodara 390 010. Tel. : +91 - 265 - 2643550, 2646021.

■ Fax : + 91 - 265 - 2641054 ■ E-mail : marketing@altopindustries.com

Factory : 392 , 419-A, GIDC, Makarpura, Vadodara - 390 010.

■ Tel. : 0265-2658480 ■ E-mail : support@altopindustries.com

MUMBAI : 5, Turakhia Park, Shopping Complex, Building No. 1, Next to Corporation Bank, M. G. Road, Kandivali (W) MUMBAI - 400 067. ■ Tel. : (022) 2806 6032 / 2806 6036 ■ Fax : (022) 2862 9113

■ Email : bombay@altopindustries.com



**ALTOP Industries Ltd.**

PROCESS CONTROL INSTRUMENTATION

CIN - U91110GJ1993PLC018831

<http://www.altopindustries.com>