

THERMOCOUPLE INSET ATC 1005

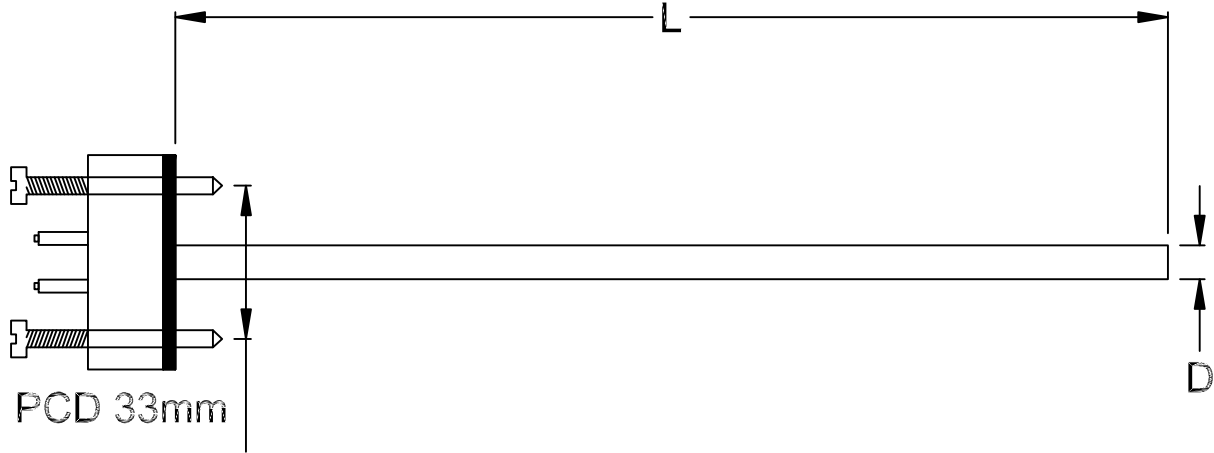

Thermocouple Type	No. of Elements	Type of Junction	Insulation	Sheath MOC	Sheath Dia "D"	Sheath Length mm "L"	Accuracy
J, K, T, E, N, R, S, B							
S Single D Double							
0G Grounded UG Ungrounded							
01 Mineral Insulated							
02 SS 310 04 SS 316 13 Inconel 600							
3 mm 6 mm x others							
___ mm							
ANSI MC 96.1 A Standard B Special							
ATC 1005							

An ISO 9001 : 2008 company

Corporate & Mktg. Office : 165, G.I.D.C. Makarpura, Vadodara 390 010. **Tel.** : +91 - 265 - 2643550, 2646021.
Fax : + 91 - 265 - 2641054 ■ **E-mail** : marketing@altopindustries.com

Factory : 392 , 419-A, GIDC, Makarpura, Vadodara - 390 010.
Tel. : 0265-2658480 ■ **E-mail** : support@altopindustries.com

MUMBAI : 5, Turakhia Park, Shopping Complex, Building No. 1, Next to Corporation Bank, M. G. Road, Kandivali (W) MUMBAI - 400 067. ■ **Tel.** : (022) 2806 6032 / 2806 6036 ■ **Fax** : (022) 2862 9113
Email : bombay@altopindustries.com



ALTOP Industries Ltd.
 PROCESS CONTROL INSTRUMENTATION

CIN - U91110GJ1993PLC018831

<http://www.altopindustries.com>