

HIGH TEMP. THERMOCOUPLE ASSEMBLY WITH WEATHER PROOF ENCLOSURE ATC 1010-A

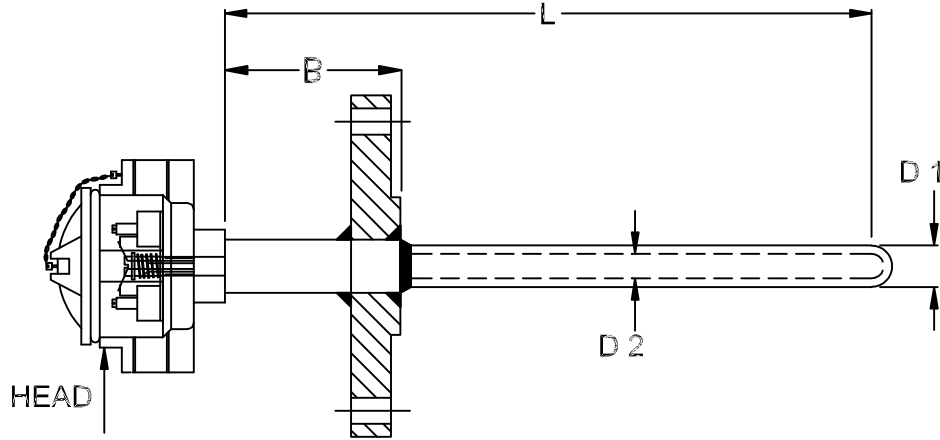

Head	Cable Gland	Process Connection Size	Collar	Thermocouple	Accuracy
------	-------------	-------------------------	--------	--------------	----------

Material	No. of Entries	Cable Entries Size	Entries Plugged
A C. Alu. WP	02	1/2" NPT	
	xx	Others	
1 Single Entry	1		
2 Dual Entry	x	None	

- O None
- A W. P. Single Compression Brass Ni Plated
- B W. P. Double Compression Brass Ni Plated
- X Others

PROCESS FLANGE WELDED ON COLLAR

MOC	SIZE	FINISH
01 SS 304	1A 1" ASA 150#	A Serrated
04 SS 316	2A 1 1/2" ASA 150#	B Smooth
12 CS	2B 1 1/2" ASA 300#	

Material	Dia	Length B
03 SS 310	___ mm	___ mm
04 SS 316	___ mm	___ mm

ANSI MC 96.1
A Standard
B Special

Thermocouple Type	No. of Elements	Type of Junction	Insulation	Element Dia	No. of Sheath	Sheath MOC		Sheath Dia		Sheath Length "L"
						Outer Sheath	Inner Sheath	Outer Sheath "D1"	Inner Sheath "D2"	
R S B	S Single	0G	02 Beaded	24 Swg	Single	1 KER 610	1 KER 610	15mm OD x 11mm ID	8mm x OD 5mm ID	___ mm
	D Double	Grounded UG		25 Swg		2 KER 710	2 KER 710	20mm OD x 15mm ID	12mm x OD 8mm ID	
		Ungrounded		26 Swg						
K				12 Swg				24mm OD x 18mm ID	15mm x OD 11mm ID	
				14 Swg						

ATC 1010-B

An ISO 9001 : 2008 company

Corporate & Mktg. Office : 165, G.I.D.C. Makarpura, Vadodara 390 010. Tel. : +91 - 265 - 2643550, 2646021.
 ■ Fax : + 91 - 265 - 2641054 ■ E-mail : marketing@altopindustries.com

Factory : 392 , 419-A, GIDC, Makarpura, Vadodara - 390 010.
 ■ Tel. : 0265-2658480 ■ E-mail : support@altopindustries.com

MUMBAI : 5, Turakhia Park, Shopping Complex, Building No. 1, Next to Corporation Bank, M. G. Road, Kandivali (W) MUMBAI - 400 067. ■ Tel. : (022) 2806 6032 / 2806 6036 ■ Fax : (022) 2862 9113
 ■ Email : bombay@altopindustries.com

ALTOP Industries Ltd.
 PROCESS CONTROL INSTRUMENTATION
 CIN - U91110GJ1993PLC018831
<http://www.altopindustries.com>