

FABRICATED SCREWED THERMOWELL

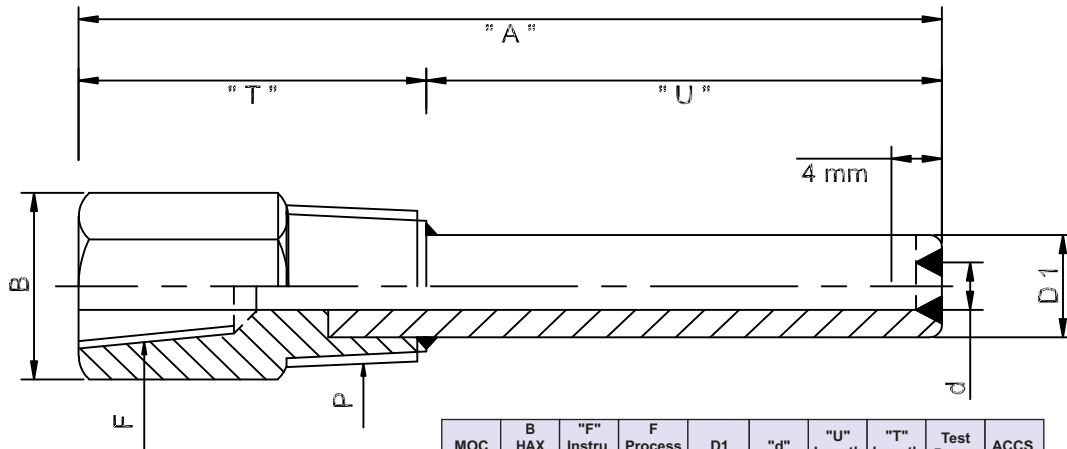

MOC	B HAX Bar Size	"F" Instru. Conect.	F Process Conect.	D1	"d"	"U" Length	"T" Length	Test Press.	ACCS.
01 SS 304	07 SS 347	14 Inconel 825	20 Titanium						
02 SS 304 L	08 SS 347 H	15 Incolloy 800	22 Kanthal						
03 SS 310	10 SS 410	16 Monel 400	23 Brass						
04 SS 316	11 SS 446	17 Nickle 200	24 Copper						
05 SS 316 L	12 CS A105	18 Hastalloy B	xx Others						
06 SS 321	13 Inconel 600	19 Hastalloy C-276							
01 1"	02 1 1/8"								
03 1 1/4"	04 1 1/2"								
xx Others									
01 3/8" BSP	03 3/4" BSP	# Female Thread							
01A 3/8" NPT	03A 3/4" NPT								
02 1/2" BSP	xx Others								
02A 1/2" NPT									
01 3/8" BSP	03A 3/4" NPT	# Male Thread							
01A 3/8" NPT	04 1" BSP								
02 1/2" BSP	04A 1" NPT								
02A 1/2" NPT	04B M 33 x 2								
03 3/4" BSP	xx Other								
0A 1/2" Sch. 40	0C 3/4" Sch 40	# Seamless							
0B 1/2" Sch. 80	0D 3/4" Sch 80								
1" Sch. 80	xx Others								
_____ mm ID									
_____ mm									
01 50 mm									
xx Other									
01 50 Kg/Cm ²									
xx Other									
X None	02 Copper Washer								
01 Plug and Chain	xx Others								
ATW 1012-A									